

Chamfered Square Nut

Thread Type: Metric - Coarse

Thread Direction: Right Hand

Material: Carbon Steel

Class Grade: Low Tensile Class 5

Finish: Galvanised

Corrosion Protection Level: Excellent

Standard: DIN 557

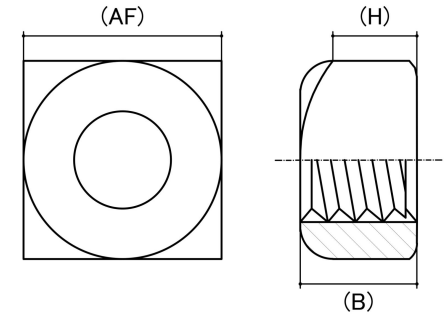

*CAD drawings shown for graphic representation only.**

Size	Thread Pitch (mm)	Thread Type	Overall Nut Height (B) (mm)		Hex Height (H) (mm)	Across Flats (AF) (mm)		Spanner Size (AF) (mm)	sku (qfind)
			Min	Max	Nom	Min	Max		
M6	1.00	Coarse	4.52	5.00	3.20	9.64	10.00	10	41SQ6G
M8	1.25	Coarse	5.92	6.50	4.10	12.57	13.00	13	41SQ8G
M10	1.50	Coarse	7.42	8.00	5.20	16.57	17.00	17	41SQ10G
M12	1.75	Coarse	9.42	10.00	6.60	18.48	19.00	19	41SQ12G
M16	2.00	Coarse	12.30	13.00	8.60	23.16	24.00	24	41SQ16G
M20	2.50	Coarse	15.30	16.00	-	29.16	30.00	30	41SQ20G
M24	3.00	Coarse	18.30	19.00	-	35.16	36.00	36	41SQ24G

Disclaimer:

Dimensional data and technical information was obtained from publicly available sources and not acquired through standard agencies. It has been completed and compiled for reference purposes only; where discrepancies are found they are subject to change without notice. Bolt & Nut Australia makes no warranties or representations regarding the accuracy and validity of the compiled information and data. Contact the relevant standard authorities for accurate and detailed information.

* CAD drawings may not reflect diameter, thread length or overall length.

© Bolt & Nut Australia Pty Ltd. All rights reserved.

Version: 18 Mar 2024